



Serie



75 Máxima

Especificaciones Técnicas

Carpintería practicable con Rotura de Puente Térmico

Cámara Europea

Junta abierta con Junta Central

Sección de Marco 75 mm.

Sección de Hoja 82 mm.

Galce de vidrio de 26,5 a 60,5 mm.

Peso Máximo por : Hoja Practicable : 120 Kg.⁽¹⁾

Hoja Oscilo- Batiente : 130 Kg.⁽¹⁾

Hoja Oscilo- Batiente Herraje Oculto : 170 Kg.⁽¹⁾

Medidas Máximas por Hoja para todas las aperturas :

1700 mm. x 2500 mm.⁽¹⁾

(1) Consultar rangos de aplicación con nuestro Dpto. Técnico Comercial

Clasificación obtenida

Permeabilidad al aire*	CLASE 4
Estanqueidad al agua*	CLASE E1650
Resistencia al viento*	CLASE C5
Transmitancia térmica**	1,3 W(m ² K)
Aislamiento Acústico***	44 (-1;-5)dB

* Ventana de 2 hojas de 1230 x 1480 mm .

** Ventana de 1 hoja de 1230 x 1480 mm ; Vidrio Uv: 0,7 W(m² K)

*** Ventana de 2 hojas de 1230 x 1480 mm ; Vidrio 6+6 Silence/24/4+4 Silence

Posibilidades de Apertura

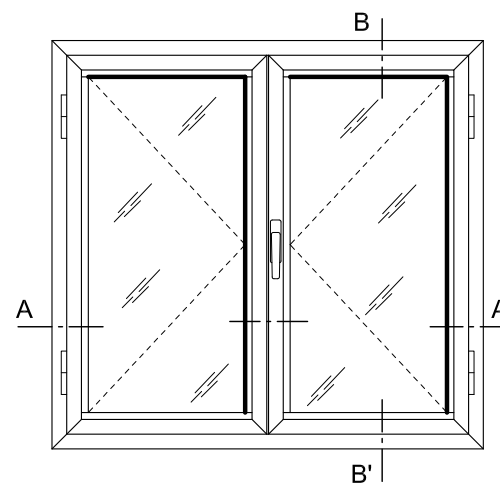
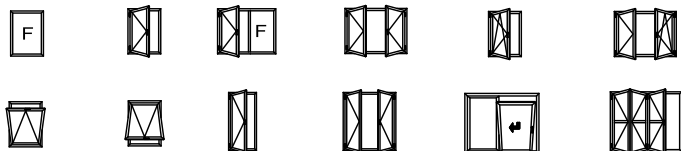

VENTANA 2 HOJAS PRACTICABLES

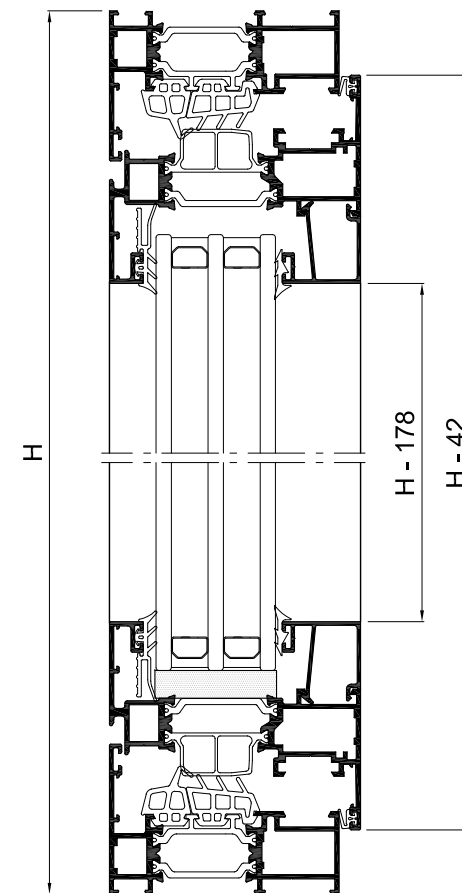

Sección B-B'

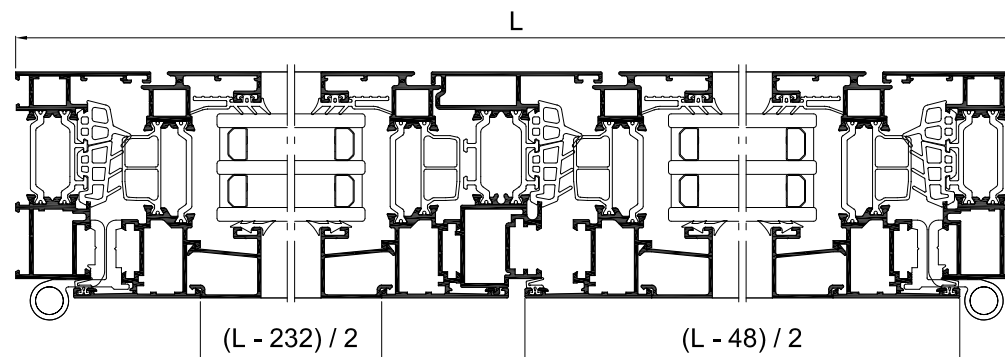

Sección A-A'

* Tabla de Junquillos 2 (Altura 22 mm)

Perfiles **alg** 75 Máxima

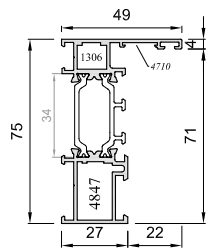

16070H

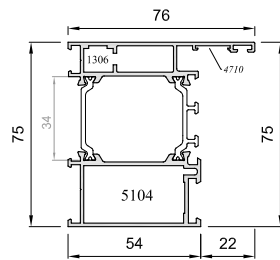

16300H

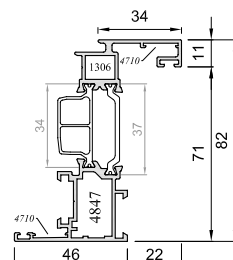

16064H

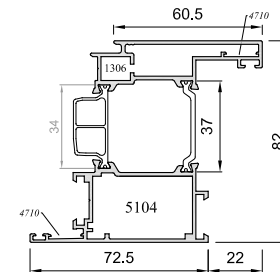

16218H

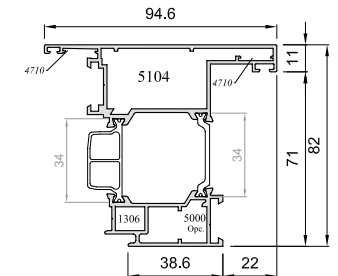

16303H

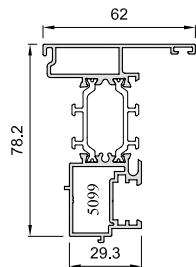

16088H

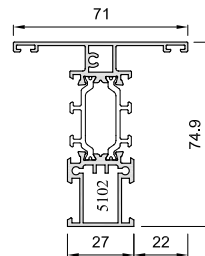

16197H

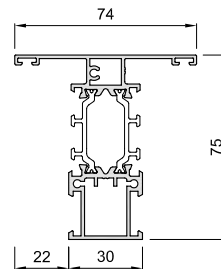

16339H

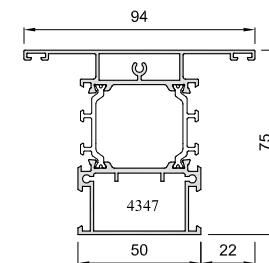

16305H

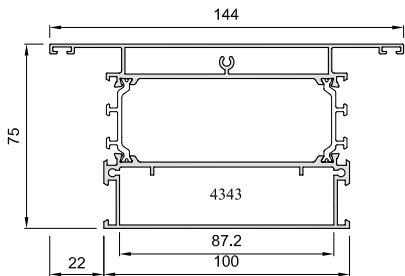
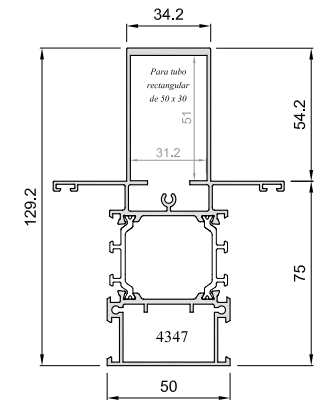

16310H

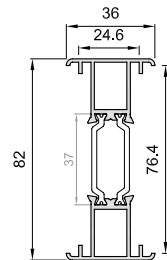

8482H

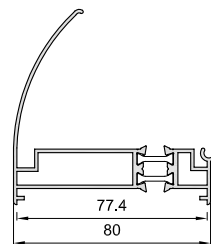

8592M

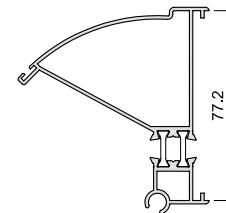

8591M

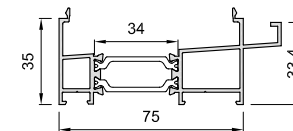

16319H

Este folleto tiene un valor meramente informativo.
El Grupo Alugom se reserva el derecho a realizar cualquier tipo de modificación, anular, eliminar definitiva o parcialmente, o quitar de stock cualquier perfil y/o accesorio que aparece en este documento, sin previo aviso.

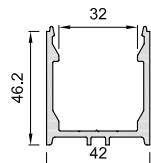

628
6806

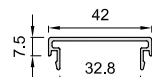

629
6807

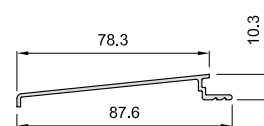

16324



8428



8412

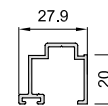

8891

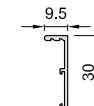

16321

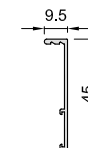

16322

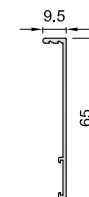

16323



Accesorios

alg 75 Máxima



4024
Cremona EURO



4019
Cremona EURO Os-Ba

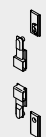

4025
Kit Cremona EURO



4724
Bisagra Os-Ba Simétrica 2º Hoja

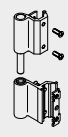

4727
Bisagra Flash Izquierda/Derecha

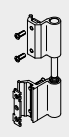

4728
Bisagra Flash Izquierda



4739
Terminal pletina metálico



4840
KIT Pasador hoja pasiva metálica (sup. e inf.)



4010
Bisagra compás corto ralenti



4085
Bisagra compás largo ralenti



4842
Cerradero sup. regulable OS-BA



4720
Cerradero lateral doble pletina Zamak



4847
Escuadra Marco/Hoja



1306
Escuadra Exterior

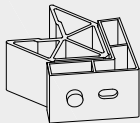

5104
Escuadra balconera alg



4846
Tercer punto de cierre



5002
Cierre suplem. entre hojas



4008
Patin apoyo hoja



4337
Embelle. salida agua c/ membrana

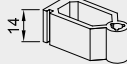

5102
Taco pilastra ventana alg



4347
Taco pilastra ancha alg

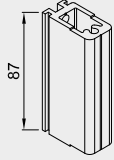

4343
Taco manguetón

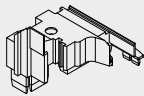

5099
Juego tapajuntas acople alg 75



5073
Junta central



5074
Refuerzo Junta central alg 75

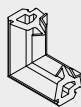

5105
Angulo vulcanizado junta central



4850
Goma exterior acristalamiento con alas



5085
Junta perimetral hoja alg

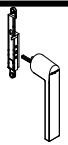

Manilla HP Ultra Alugom

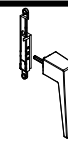

5143
Manilla HP Ultra Cuadrada



5144
Manilla HP Ultra Redonda

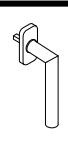

5079
Manilla inox. recta

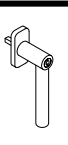

5080
Manilla inox recta c/llave



5086
Manilla inox recta acodada

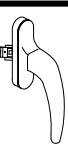

4725
Cremona Prima Os-Ba

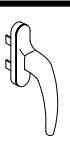

4723
Cremona Prima Pract.



4792
Cremona Prima c/llave

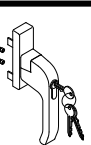

4707
Cremona EURO c/llave

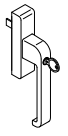

4096
Cremona Os-Pa con llave



1044
Cierre presión (Pequeño)

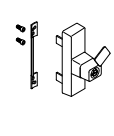

4704
Cremona desmontable Euro

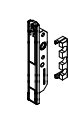

4613
Mecanismo Cuadrad. bidirec. practicable



5081
Mec. Cuadrad. unidirec. OS-BA

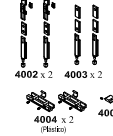

4380
Kit Cremona Euro 2 Hojas (sin cremona)

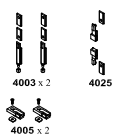

4714
Kit Cremona Euro 1 Hoja

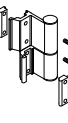

4390
Bisagra regleta Ø 14 mm.

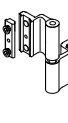

4768
Bisagra 3º Hoja

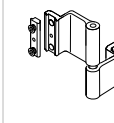

4769
Bisagra Extremo "Jirafa"



4352
Bisagra ventana 3 hojas

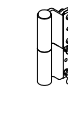

4744
Bisagra Puerta 24,5 mm. Izda.

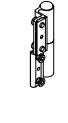

4745
Bisagra Puerta 24,5 mm. Deha.



4002
Pasador oculto long. variable

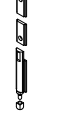

4003
Terminal de pletina cremona



4860
Pasador bidirecci. Palanca

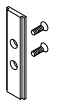

4007
Cierre complem. cremona

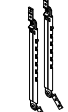

4011
Bisagra compás regul. proyectante



4009
Cierre cangrejo Interno

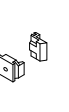

4366
Cierre bisagra oculta

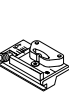

4848
Microventilación practicable



5026
Bulón regulable



4005
Cerradero lateral pletina Nylon

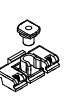

4754
Retenedor de hoja



4004
Cerradero lateral doble pletina Nylon

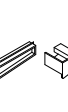

4043
Juego tapas condensación

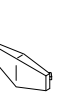

4035
Embellecedor salida agua



4708
Escuadra ángulo variable

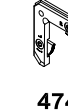

4742
Escuadra alineamiento excéntrica



4710
Escuadra alineam. 14 mm.

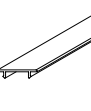

4994
Tapa rígida canal



4741
Goma para batiente



5140
Junta perimetral base rígida alg



4303
Junta acústica cerco



5096
Banda aislante cerco 5 x 35



4090
Goma interior acrist. de 4 a 6mm.



5261
Goma interior acrist. de 8 a 10 mm.



4379
Junta acústica cerco

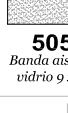

5051
Banda aislante vidrio 9 x 40



4089
Goma interior acrist. de 2 a 4mm.



4091
Goma Interior acrist. de 6 a 8mm.



4057
Goma exterior acristalamiento

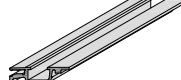

5120
Pieza soporte clip Interior

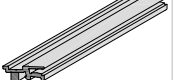

5121
Pieza soporte clip Exterior

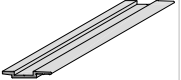

5122
Pieza soporte clip plano



5087
Termostato 28 x 12 [A] (En barras de 700 mm.)

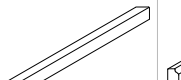

5088
Termostato 10 x 12 [B] (En barras de 700 mm.)



5089
Termostato 32 x 9 [C] (En barras de 700 mm.)



5108
Termostato 27 x 14 [P] (En barras de 700 mm.)

Accesorios Varios

- 5123 Fresa Cerco alg 75 Máxima
- 5124 Fresa Hoja alg 75 Máxima
- 5112 Util alg 75 Máxima
- 4753 Cerradura vertical tradicional con palanca deslizante
- 4755 Cerradura vertical de seguridad con palanca basculante
- 4790 Cerradura de cámara Europea para pletina falleba
- 4865 Cerradura sobrepuesta compacta de seguridad multipunto (3 puntos)

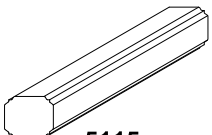

5115
Termostato 35 x 34 [T3] (En barras de 700 mm.)

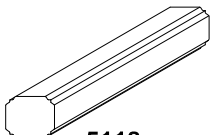

5118
Termostato 39 x 35 [S1] (En barras de 700 mm.)

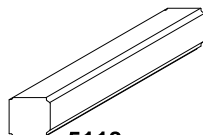

5113
Termostato 33 x 37 [S2] (En barras de 700 mm.)

